



# Kansas-Missouri Company

## NEWSLETTER

VOL. 3, NO. 2

NOVEMBER 2009

### JAMESTOWNE SOCIETY

Kansas-Missouri Company  
*will meet at*

#### Milburn Golf & Country Club

**7501 West 69th St.**

**Overland Park, Kansas**

**Sunday, November 15, 2009**

*Twelve-thirty Social Time*

*Prayer & Pledge of Allegiance*

*One O'Clock Luncheon (\$19.00 per person)*

#### **Speaker**

**Jim Beckner**

**“Bacon’s Rebellion**

**&**

**The Burning of Jamestowne”**

Reservations close Thursday

November 12, 2009

Make checks payable to

Jamestowne Society

Kansas-Missouri Company

P.O. Box 1246

Independence, MO 64051-0746

*Please include names of all  
people in your party.*

*Name tags will be available for pickup at the  
Hospitality Table before the meeting.*

*Membership dues are collected  
annually in November.*

*Please remit \$10.00 with your check.*

**No late reservations or walk-ins accepted.**

### GOVERNOR’S MESSAGE

Autumn is upon us as winds swirl gold and russet leaves throughout neighborhoods, bringing with it a chill, to remind us that winter is on the way.

In a few weeks, we will continue an American tradition by celebrating Thanksgiving with family gatherings and feasts of pumpkins, turkeys, corn and squash. Foods that we know are indigenous to America and the planting and growing of such that was first taught to colonists by the Indians.

Thanksgiving was declared a legal holiday by President Abraham Lincoln to commemorate the Pilgrims as the founders of America who celebrated the first feast at Plymouth in 1621. The colonists invited the Wampanong people to help celebrate the ending of autumn by giving thanks to God for the harvest and good health.

During our many school years, textbooks have taught us that at the first Thanksgiving, the Indians had never seen such an abundance of food. However, we know now the Indians had always celebrated the end of autumn and harvest time with feasts. Indeed, it was the Pilgrims who had never

*continued on page 2*

#### TABLE of CONTENTS

Governor’s Message .....	Page 1
Meeting Announcement .....	Page 1
Introducing New KS-MO Company Officer .....	Page 2
Happy Birthday to a Special member .....	Page 2
Kansas-Missouri Fall News .....	Page 3
In Memoriam .....	Page 3
Governor’s Roundtable Meeting .....	Page 4
Jamestowne: The Garden of the Church .....	Page 5
Lawes Devine, Morall and Martiall .....	Page 6
Hmmms and Ahhhs .....	Page 7
Map and Directions to Milburn Country Club .....	Page 8

## **GOVERNOR'S MESSAGE, *continued***

seen such an abundance of food. According to Dr. Chris Sizemore's program in May 2009, the first Thanksgiving in the New World was actually celebrated in 1619 at Berkley Hundred a few miles North of Jamestowne, not by the Pilgrims at Plymouth. Rarely, if any, is this mentioned in children's textbooks. Consequently, children and even adults are much more likely to remember the Pilgrims as founders of our great Nation rather than our Jamestowne ancestors.

When our families meet to celebrate Thanksgiving this year to enjoy bountiful foods, remember to give 'thanks' for our Jamestowne ancestors who endured many hardships so that each of might have the freedom and opportunity to pursue a better life with good health and happiness.

Dessa Jane Burrell, Governor

### **HAPPY BIRTHDAY TO A SPECIAL MEMBER**

Best wishes to Mrs. Fern Parks of Independence, Missouri who will celebrate her 100<sup>th</sup> Birthday on October 22, 2009. Fern is a graduate of the Kansas City Business College and worked several years as a Secretary for Butler Manufacturing Company. She met her husband, Lawrence, at Church and they were married September 1, 1929. Her husband has since passed away, as well as one of their four children.

Fern has ten grandchildren, fifteen great-grandchildren and four great-great-grandchildren. Her family has planned a big celebration for her on her birthday. She is a member of the DAR Independence Pioneer Chapter and was given a birthday card celebration at their latest meeting. The Mayor of Independence has proclaimed October 22 as Fern Park's Day!

### **INTRODUCING A NEW KANSAS-MISSOURI COMPANY OFFICER**

Mr. Gordon Fristoe has accepted the position of Treasurer and brings years of experience in banking and management to our Company. He was born in Kansas City and lived a short time in Pratt, Kansas, during WWII, but spent his youth in Independence and Odessa, Missouri.

He earned a Bachelor Degree in Business and Economics from Drury (now University) College in Springfield, Missouri. His business career has been in management, with most of his time in Information Processing (computers) and banking.

Gordon served five years in the US Army with a year in Korea and a year in Vietnam. In 1993, he and his wife, Barbara, returned to their roots in Missouri. She continued to teach school and he made a major career change. He is now involved with raising cattle and managing rental property that they acquired in Odessa.

He got a late start in researching his family history and discovered everything he had been told was wrong. This became his new challenge and the discovery of a Jamestowne ancestor, William Hampton. This led to a fourth great-granddaughter, Mary Hampton, who married Joseph De Jarnett, the grandson of a French Huguenot and a Lieutenant in the Revolutionary War.

The De Jarnett's granddaughter married Amos Fristoe whose father, Thomas, was a major in the War of 1812. Amos and his wife, Susan, brought their family to Pettis County, Missouri, in 1830. Amos was the first County Clerk of Pettis County and served for 17 years. He also served two terms in the Missouri State Legislature. Three of Amos's sons served in the Confederate Army.

His mother's family was early Scots immigrants. His third great-grandfather, George Gordon, served in the Pennsylvania Line and spent the winter at Valley Forge during the Revolutionary War.

Gordon has four daughters and nine grandchildren.

William Hampton came to Virginia in 1621 on the *Bona Nova*. He and his wife, Joane, were living on the east side of the Hampton River in Elizabeth City in Buckroe. Their household also included a John Arundell who was age 22. They also lived near Capt. Francis West. More information about William Hampton may be found in *Virginia Immigrants and Adventurers, 1607-1635: A Biographical Dictionary* by Martha W. McCartney.

## KANSAS-MISSOURI FALL NEWS

Recent New Members whose papers have been confirmed by the National Jamestowne Membership Committee are as follows:

- 7279 Mrs. Ralph Dennis Weed (Barbara Myers) of Overland Park, Kansas  
Ancestor: William Hatcher. Confirmed 1/9/2009
- 7297 Mrs. Natale Scavone (Bette Jeanne Keene Martin) of Columbia, Missouri  
Ancestor: John Woodson. Confirmed 1/27/2009
- 7328 Mrs. Daryl Lee Taylor (Carolyn Janis Goodnow) of Overland Park, Kansas  
Ancestor: William Hatcher. Confirmed 3/25/2009
- 7337 Mrs. James Dean Cline (Betsy Darlene Roberts) of Mexico, Missouri  
Ancestor: John Clay. Confirmed 4/9/2009
- 7364 Mrs. Javier Francisco Ocasio (Kathleen Jayne Knott) of Bellevue, Nebraska  
Ancestor: Peter Montague. Confirmed 6/3/2009
- 7375 Mrs. Stephen Jeffry Olson (Elaine Kay Hill) of Marshall, Missouri  
Ancestor: William Hampton. Confirmed 6/30/2009
- 7417 Dr. Scott Wright Sumerall of Smithville, Missouri  
Ancestor: Pocahontas/Matoaka/Mrs. John Rolf. Confirmed 9/12/2009

Congratulations to each of you and we invite you to become members of the Kansas-Missouri Company.

- ❖ Please be reminded that the Fall meeting will be held on Sunday, November 15 this year. Also, the social time will convene an hour later at 12:30 p.m. with lunch served at 1:00 p.m.
- ❖ The 2009 Yearbook will be distributed to those who did not attend the May 9, 2009 spring meeting.
- ❖ Faye Weems, National Executor Director, has asked members to please notify address changes as soon as possible to the Company Governor, who in turn should notify her. Printing costs of the newsletter and mailings are expensive and the office must pay for the return postage.
- ❖ When proposing a prospective member to the National Membership Committee, please forward a copy of the letter to the Company Governor.
- ❖ Mrs. Patricia Horton has tendered her resignation as Company Treasurer in order to pursue other interests. On behalf of the membership, we thank her for her five years of service. We wish her well with her new endeavors.

### In Memoriam

Mrs. Jeanne Brock Bunn passed away on March 27, 2009 in Prairie Village. She is survived by her husband, Stuart, two sons, James and Steven, and a daughter, Jennifer Bunn Weddle. All graduates of the University of Kansas.

Mrs. Bunn also leaves five grandchildren, and a great-grandson.

From *University of Kansas Alumni News*

**THE JAMESTOWNE SOCIETY**  
**GOVERNOR'S ROUNDTABLE MEETING**  
**May 15, 2009**

Mrs. Carolyn K. Farmer, Companies Chairperson, called the meeting to order at 10:30 a.m. on May 15, 2009 at the Williamsburg Lodge located in Williamsburg, Virginia.

In attendance were fifteen Governors and Delegates, eight Council Members and National Officers.

Mrs. Farmer began the meeting with a discussion of the goals of the Society starting with the importance of promoting interests in the unique history of the first colony, Jamestowne. And what methods might be explored to increase membership with using available resources and networking.

Governor Carter Furr gave the opening remarks and introduced the officers with each giving a report of their duties. Governor Furr reported that the Society is still receiving a good number of new members and as of April 30<sup>th</sup> there were 84 new members. He discussed the assets of the Society's investments that were down from where it had been. And the previous month, an amount from the investments was to be transferred over for the Society's operations. The following is a number of funds that the Society has to which the Companies and individuals have contributed:

- 1) Restoration of Records Window Fund where court records are stored.
- 2) Building Fund for improvements of the Richmond office.
- 3) Preservation of Virginia money that is for the Preservation of Virginia.
- 4) Mortgage Reduction Fund contributions that help reduce the office mortgage.
- 5) Our Fellowship Fund, a scholarship fund that contributes \$3,000 a year to graduates, mostly for the William and Mary College.

A new Charter was confirmed by the Council to be called the Florida Gulf Coast Company. The Governor is Mrs. Ruth Hemmingway.

Following are reports of the National Officers with concerns for all Company members summarized from the notes of the Secretary of State, Dr. Michael Frost:

Attorney General and Webmaster is Susan Rager who gives opinions when needed. As Webmaster,

she keeps the national website for Jamestowne current with announcements regarding meetings and events of interest.

Historian, Ann Darst, requests that biographies of ancestors be submitted for the newsletter. Also, she recommended that Companies might consider a goal of donating money toward one month's mortgage payment of \$755.43 for the National office.

Executive Director, Faye Weems, is responsible for all incoming mail in the National office. She requests that individuals pursuing membership in the Jamestowne Society should not be referred to the National office for they will be referred back to the local company for assistance. When recommending a new person, only one person per company should submit a proposal for membership.

Information Technology, Dr. Walter Beam, developed software for digital images of all membership applications. None is digitally readable. The current unreadable applications must be converted to the new PDF application form. The objective is to make it possible to look up any intermediate ancestor. Faye Weems added that each person must submit two copies of an application and to email them as attachments. The applicant should make copies for themselves of everything that is required and any additional information for the Office is not responsible for any additional paperwork. If two copies are not sent initially, and the applicant wants a copy, then there will be a charge of fifty cents per page plus \$2.50 for postage.

Dr. Beam stated that PDF is not software for it is known as Acrobat Form. The first PDF software was sent out March 26, 2009. All applications have been scanned into a PDF form and placed on a disk with a copy sent to Dr. Beam and Harrison Schroeder and one filed with Faye Weems in the office.

Membership Chair, Carolyn Farmer, reported that a few companies have not complied with the National Bylaws regarding their Company

*continued on page 6*

## JAMESTOWNE: THE GARDEN OF THE CHURCH OR THE WILDERNESS OF THE WORLD?

Dr. Chris Sizemore, Educator/Minister, was speaker for the spring meeting. His program was about religion in early Colonial Virginia. The following is a summary of his report:

Religion was not the important factor in the lives of the Jamestowne colonists, the stockholders of the Virginia Company had invested in a 'for-profit' venture. The head right system provided prospective immigrants a strong incentive to seek their fortune in Virginia. Religion, however, was a somewhat subtle but still an expectant constant in the daily lives of the colonists.

There is a lack of sources portraying the religious life of the colony, but a number of documents have survived that include the following:

Diaries and personal narratives, such as that of Capt. John Smith; letters; laws and legislative records, church records; reports and records, such as those of the Virginia Company of London; sermons and 'Wills.'

'Wills' offer a number of insights into the religious thought and practice of the times. Over 85% of the existing 'Wills' contain Christian references such as resurrection, forgiveness of sins, hope of salvation and requests for a Christian burial.

The Virginia Company investors believed that God had preordained the English colonization of the North American continent and that they shared a special relationship with God and they were 'God's Chosen People.'

Written into the Virginia statutes, the colonists were prohibited from marrying the natives because it would create an 'abominable mixture.' (A term taken from the Bible) John Rolfe was the first to confront this prohibition and eventually allowed to marry Pocahontas when she was baptized. In addition, records indicate that a number of Native American women who converted to Christianity were also allowed to marry colonists.

In 1619, the first Virginia Assembly enacted several laws requiring that the Sabbath be observed along with weekly church attendance. Also enacted were taxes to support the church and

the clergy. There were 14 services held each week and nonattendance at church was the most frequently prosecuted 'crime' in the colony. Punishments were severe even with the threat of death after a few offenses.

Laws were also enacted by the General Assembly to establish an Anglican Church with the Church of England and they were used interchangeably. There was no separation between church and state. Adherents of other religious faiths were prohibited from worshiping and building a church. Only one Catholic was ever allowed to serve in the House of Burgesses. The Church of England was the established church in Virginia until 1786 with the adoption of the Virginia Statute for Religious Freedom. At that time, the Anglican Church in the United States became the Protestant Episcopal Church.

Throughout the colonial period, the shortage of ministers was a great problem for the Church of England. The lack of a resident bishop meant that there was no traditional supervision, guidance, support, or an advocacy for the clergy. By the end of the 17<sup>th</sup> century, this lack of supervision on the part of the Church of England led to vestrymen becoming a dominant influence on church affairs. Vestrymen levied the taxes, recruited and paid the clergy, built church buildings and provided support for the needy. As a result, being a vestryman was a requirement for political office.

The Anglican gentry in Virginia had long been viewed as having a shallow faith and attendance was more of habit and need for social and political contact. The church was more practical than theological and more introspective than missionary. History can be nearly accurate in portraying the Jamestown colonists as adherents of a moderate faith but a faith that positively influenced the character and demeanor of those who laid the foundation for the Protestant Episcopal Church that we know today.

Dr. Chris Sizemore distributed handouts entitled: *Lawes Divine, Morall and Martiall*, printed on page 6 of this newsletter.

### *Lawes Divine, Morall and Martiall*

The following is a simplified version of some of the Lawes Divine, Morall and Martiall, etc. compiled by William Strachey in 1611:

Every man and woman shall attend church services twice a day on each work day upon hearing the tolling of the bell. Nonattendance will result in losing his or her day's rations for the first offense, being whipped for the second offense, and being condemned to the galleys (probably refers to some type of coastal sea service) for six months for the third offense.

Every man and woman shall attend church service on Sunday morning and afternoon. Nonattendance will result in loss of provisions and allowance for a whole week on the first offense. For the second offense, he or she shall lose their allowance and be whipped. For the third offense, he or she shall suffer death.

Anyone who takes an oath untruthfully or gives false testimony about another person shall be punished with death.

No one shall criticize, tell lies about, disobey or resist the orders of the Lord Governor and Captain General, Lieutenant General, Marshall, Council, or any authorized Captain or public officer. For doing so the first time, one will be whipped three times and must, upon his knees, ask forgiveness on Sunday before the church congregation. For a second offense, one will be condemned to the galley for three years. For a third offense, one will be punished with death.

No man shall say or do anything to disgrace another person in the colony. For doing so, one will have his head and feet tied together every night for one month and will be publicly disgraced himself. He will forever after be unable to possess any place or hold any office.

No man, unless appointed by a lawful authority, shall barter or trade with the Indians, upon pain of death.

No man shall take away anything by force from any Indian coming to trade or in any other situation, upon pain of death.

No man shall take, lose, or willfully break a spade, shovel, hatchet, axe, or other tool, upon pain of whipping.

Every tradesman shall work at his trade dutifully each day or lose meals for one month for the first offense, three months for the second offense, and one year for the third offense. If he continues to be negligent in his work, he will be condemned to the galley for 3 years.

No man or woman shall run away from the colony to the Indians, upon pain of death.

Anyone who robs a garden, public or private, or a vineyard, or who steals ears of corn shall be punished with death.

No member of the colony will sell or give any commodity of this country to a captain, mariner, master or sailor to transport out of the colony, for his own private uses, upon pain of death.

### **GOVERNOR'S ROUNDTABLE**, *continued*

reports each year. She reiterated the membership fee for new members increased on January 1<sup>st</sup> this year to \$400.00. The November Council voted to increase 'supplementals' to \$125.00.

All amendments made to the National Bylaws should automatically become a Company Bylaw. Specific Company members may vote to accept or change their own Bylaws only with

the approval of members' votes.

There has been some confusion regarding company officers with title of 'Registrar.' Consequently, Companies should now use only 'Genealogist'. Registrar is a title used only in the National office. Prospective members should be referred to the Company Genealogist or Membership Chairperson for assistance.

## **“Hmms and Ahhs”**

*“Those who do not treasure up the memory of their ancestors  
do not deserve to be remembered by their posterity.”*

----Edmund Burke

*“The very concurrence and coincidence of so many evidences  
that contribute to the proof, carries a great weight.”*

----Sir Matthew Hale

“Philosophy begins when human beings start trying to understand the world,  
not through religion or by accepting authority but through the use of reason.  
This seems to have begun among the early Greeks in the 6<sup>th</sup>, 5<sup>th</sup>, and 4<sup>th</sup> centuries B.C.  
Their earliest questions were: “What is the world made of?” “What holds the world up?”  
But then came Socrates, the most famous of all Greek philosophers who said that what  
matters most is how we ought to live. His basic question was:  
“What is Justice?”

From *The Story of Thought* by Bryan Magee

### **GRANDMA**

In the dim and distant past,  
When life's tempo wasn't so fast,  
Grandma used to rock and knit,  
Crochet, tat, and babysit,  
When the kids were in a jam,  
They could always call on Gram,  
But today she's in the gym  
Exercising to keep slim,  
She's checking the web or surfing the net,  
Sending some email or placing a bet,  
Nothing seems to stop or block her,  
Now that Grandma's off her rocker.

*Author Unknown*

**MAP AND DIRECTIONS TO  
MILBURN COUNTRY CLUB  
7501 West 69<sup>th</sup> Street  
Overland Park, Kansas  
913-432-0490**

Driving west from St. Louis and Columbia, Missouri, the best route is I-70 to the downtown Kansas City Metropolitan area. Take I-70 into Kansas City until you see the exit downtown for I-35. Take I-35 south (toward Wichita, not Des Moines) until you reach the Metcalf exit. Continue south on Metcalf Avenue to 69<sup>th</sup> Street. Turn right on 69<sup>th</sup> Street until you see Milburn Country Club, 7501 West 69<sup>th</sup> Street, Overland Park, Kansas. It will be straight ahead.

Should you end up on I-670 into Kansas, keep driving until the I-635 exit sign and take the southbound exit ramp that will eventually merge into Metcalf Avenue. This is an easier route but a longer drive.

Those of you who live in Wichita, I-35 will take you into Overland Park, but use the 75<sup>th</sup> Street exit ramp and drive to Metcalf Avenue. Turn left to 71<sup>st</sup> Street at the traffic light. On 71<sup>st</sup>, drive to the first stop sign and turn right on Santa Fe. This will lead you to Milburn.

Those living in Topeka, Kansas may take either I-435 or I-70. You can connect with I-635 southbound

which merges with Metcalf. Follow Metcalf to 69<sup>th</sup> Street and turn right. This will lead you to Milburn Country Club.

Those living south near I-435 take the Metcalf exit ramp, staying on Metcalf to the traffic light at 71<sup>st</sup> and turn left. Drive to the first stop sign and turn right on Santa Fe, which will lead you to Milburn.

The keyword is Metcalf Avenue.

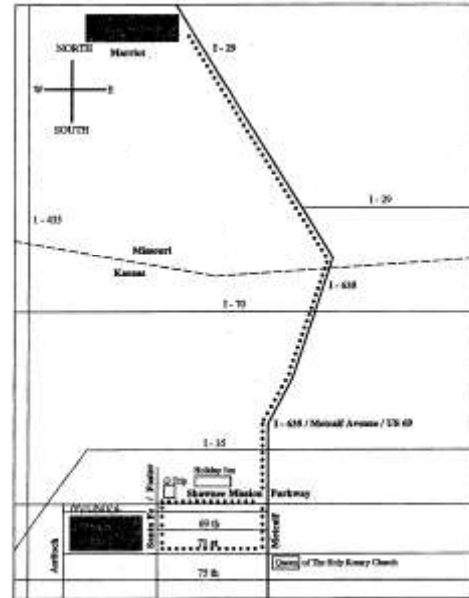

# Jamestowne Society

Kansas-Missouri Company  
P.O. Box 1246  
Independence, MO 64051-1436